

EXISTING LEGEND

- SIGN
- TELEPHONE MANHOLE
- POWER POLE
- LIGHT POLE
- ELECTRIC MANHOLE
- GAS VALVE
- GAS MANHOLE
- GAS METER
- SANITARY CLEANOUT
- SANITARY MANHOLE
- STORM INLET
- STORM MANHOLE
- WATER VALVE
- SPRINKLER HEAD (FIRE DEPT. CONNECTION)
- FIRE HYDRANT
- WATER MANHOLE
- WATER METER
- TRAVERSE

- BUILDING LINE
- INTERIOR BUILDING WALL
- PROPERTY LINE
- CURB & GUTTER LINE
- ELEVATION CONTOURS

PROPOSED LEGEND

- PROPOSED CONTOUR ELEVATION LINE
- PROPOSED PROPERTY LINE
- PROPOSED SPOT ELEVATION
- PROPOSED WHEELCHAIR-BICYCLE RAMPS WITH WARNING SURFACE. 609.09 FOR DETAILS
- PROPOSED SIDEWALK LINE
- PROPOSED CURB LINE
- PROPOSED WALL
- PROPOSED NEW CONCRETE SIDEWALK (ONSITE)
- PROPOSED NEW CONCRETE SIDEWALK (OFFSITE)
- PROPOSED LOADING DOCK DRIVEWAY
- PROPOSED COMPOSITE MATERIAL FOR PLATFORM
- PROPOSED PLANTER
- PROPOSED MICROBIORETENTION FACILITY (ONSITE SEE SHEET C0018 FOR DETAILS)
- PROPOSED MICROBIORETENTION FACILITY (OFFSITE SEE SHEET C0018 FOR DETAILS)
- PROPOSED GRASS STRIP
- PROPOSED PAVERS SEE ARCH PLANS FOR DETAILS
- PROPOSED ELECTRICAL VAULT (BY OTHERS)
- PROPOSED GREEN PILLAR OAK (QUERCUS PALUSTRIS)

CONSTRUCTION LEGEND

- PROPOSED CONCRETE CURB PER DDOT 609.01
-MATCH ELEVATION TO EXISTING CURB ELEVATION
- PROPOSED CONCRETE DRIVEWAY PER DDOT 504.01
-SIDEWALK ELEVATIONS TO MATCH ADJACENT SIDEWALK.

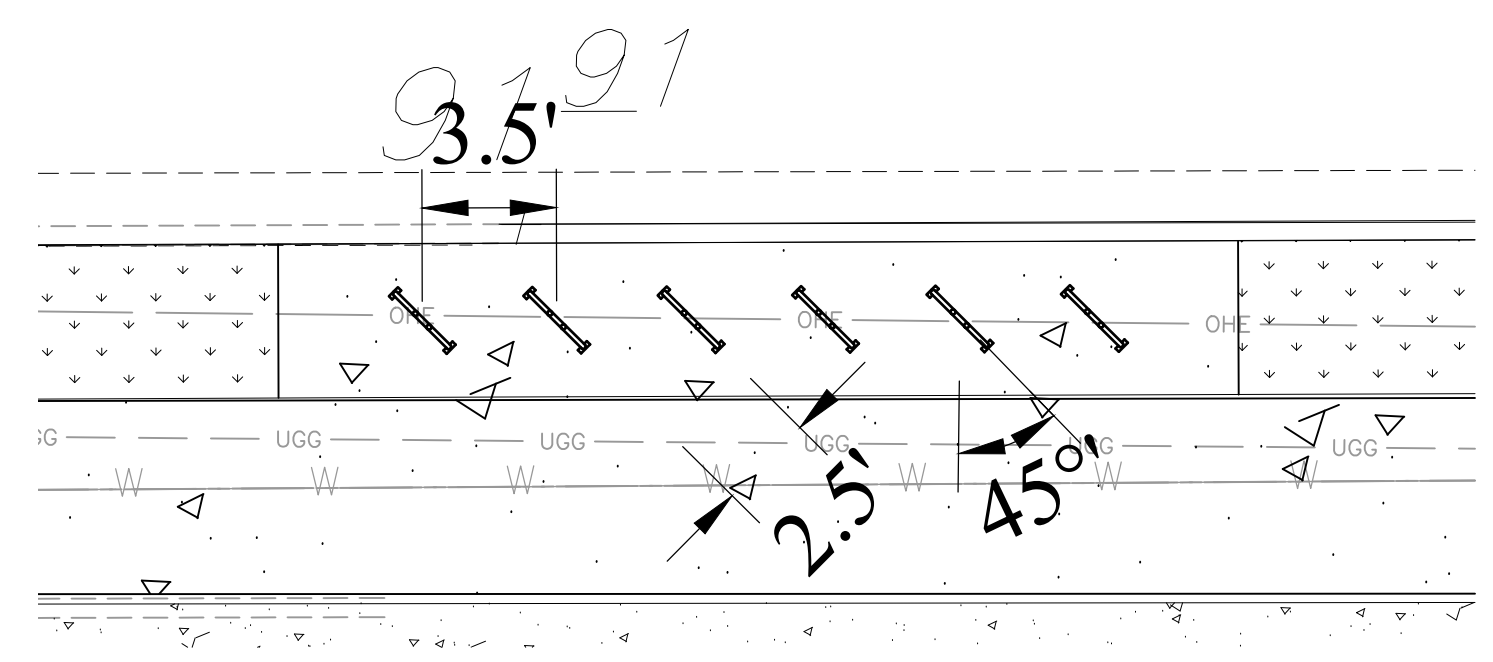

TYPICAL BIKE RACK DIMENSIONS

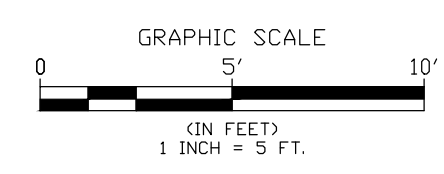

D.O.B. APPROVAL STAMPS:

12	8/31/2018	FRONT BIORETENTION REVISION
11	5/21/2018	FRONT PLANTER & REAR SD
10	8/14/2017	REAR BIO CHANGES (BIO-TABIO-4)
9	8/1/2017	FRONT INLET STRUCTURES
8	6/19/2017	BIO-2 MANHOLE
7	3/24/2017	SEWER FIELD CHANGE
6	2/1/2017	DC WATER FIELD CHANGE
5	1/11/2016	ASI 002
4	8/28/2016	DOOE APPROVAL SET
3	8/10/2016	ASI 001
2	4/27/2016	IFC SET
1	12/17/2015	DC WATER SET

Submissions & Revisions

Owner
Douglas Development Corp.
 702 H Street, NW, Suite 400
 Washington, DC 20001
 202.638.6300
 www.douglasdevelopment.com

General Contractor

Architect
ANTUNOVICH ASSOCIATES
 ARCHITECTURE • PLANNING • INTERIOR DESIGN
 2206 CLAREMONT BOULEVARD
 SUITE 1150
 BETHESDA, MARYLAND 20814
 301.234.1124

Landscape Architect

Structural Engineer
MGV Consulting Structural Engineers, Inc.
 6239 Executive Boulevard
 North Bethesda, MD 20852-3906
 301.816.0648
 www.mgvengineers.com

M.E.P. & F.P. Engineers
DJK & Associates, Inc.
 14011 Welland Terrace
 North Potomac, MD 20878
 301.309.6414
 djka@djk-ae.com

Civil Engineer
Dewberry
 2101 Gaither Rd, Suite 340
 Rockville, MD 20850
 301.948.8300
 www.dewberry.com

Project Location
PAPPAS BUILDING
 1401 Okie Street, NE
 Washington DC 20002

Drawing Title
SURFACE SITE PLAN

Seal

 Date: 11/1/18
 Drawn By: RER
 Checked By: AB
 Project No:

Drawing No.
C0003

P:\PROJECTS\2018\1401 Okie Street, NE - 60022200\CD\01\Site Plan - Construction\C0003_SSP.dwg, 11/02/2018 9:13:17 AM, RER
 C:\Users\lward\Documents\Hatch_Plan_Arch.dwg, 11/02/2018 9:46:46 AM

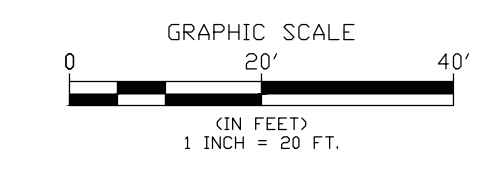
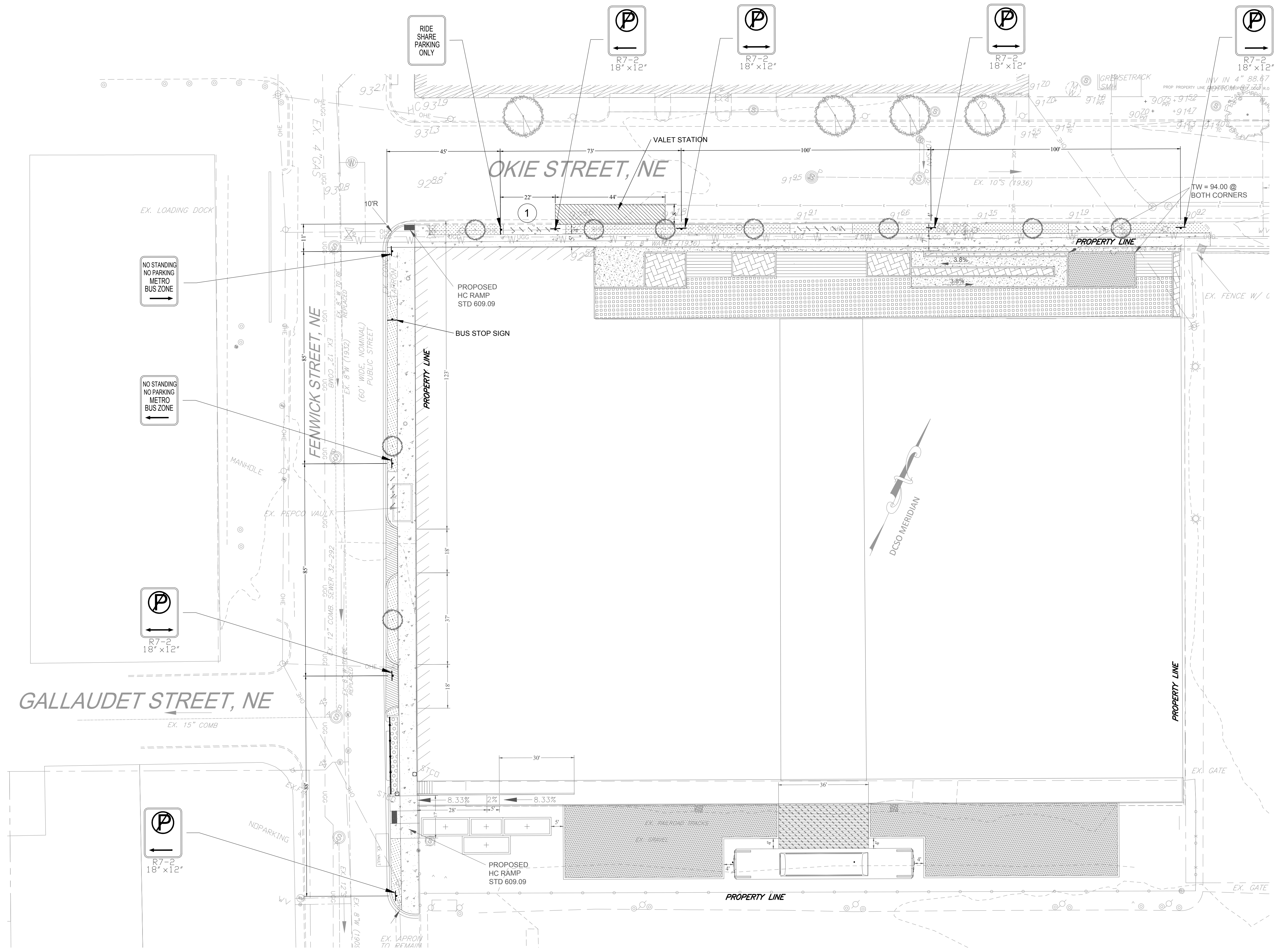

EXISTING LEGEND

- SIGN
- TELEPHONE MANHOLE
- POWER POLE
- LIGHT POLE
- ELECTRIC MANHOLE
- GAS VALVE
- GAS MANHOLE
- GAS METER
- SANITARY CLEANOUT
- SANITARY MANHOLE
- STORM INLET
- STORM MANHOLE
- WATER VALVE
- SPRINKLER HEAD (FIRE DEPT. CONNECTION)
- FIRE HYDRANT
- WATER MANHOLE
- WATER METER
- TRAVERSE

- BUILDING LINE
- INTERIOR BUILDING WALL
- PROPERTY LINE
- CURB & GUTTER LINE
- ELEVATION CONTOURS

PROPOSED LEGEND

- PROPOSED CONTOUR ELEVATION LINE
- PROPOSED PROPERTY LINE
- PROPOSED SPOT ELEVATION
- PROPOSED WHEELCHAIR-BICYCLE RAMPS WITH WARNING SURFACE. 609.09 FOR DETAILS
- PROPOSED SIDEWALK LINE
- PROPOSED BUILDING LINE
- PROPOSED CURB
- PROPOSED WALL
- PROPOSED NEW CONCRETE SIDEWALK (ONSITE)
- PROPOSED NEW CONCRETE SIDEWALK (OFFSITE)
- PROPOSED LOADING DOCK DRIVEWAY
- PROPOSED COMPOSITE MATERIAL FOR PLATFORM
- PROPOSED PLANTER
- PROPOSED MICROBIORETENTION FACILITY (ONSITE SEE SHEET C0018 FOR DETAILS)
- PROPOSED MICROBIORETENTION FACILITY (OFFSITE SEE SHEET C0018 FOR DETAILS)
- PROPOSED GRASS STRIP
- PROPOSED PAVERS SEE ARCH PLANS FOR DETAILS
- PROPOSED ELECTRICAL VAULT (BY OTHERS)
- PROPOSED GREEN PILLAR OAK (QUERCUS PALUSTRIS)

D.O.B. APPROVAL STAMPS:

12	8/31/2018	FRONT BIORETENTION REVISION
11	5/21/2018	FRONT PLANTER & REAR SD
10	8/14/2017	REAR BIO CHANGES (BIO-TABIO-4)
9	8/1/2017	FRONT INLET STRUCTURES
8	6/19/2017	BIO-2 MANHOLE
7	3/24/2017	SEWER FIELD CHANGE
6	2/1/2017	DC WATER FIELD CHANGE
5	1/18/2016	ASI 002
4	8/28/2016	DDOE APPROVAL SET
3	8/10/2016	ASI 001
2	4/27/2016	IFC SET
1	12/17/2015	DC WATER SET

Submissions & Revisions

Owner
Douglas Development Corp.
 702 H Street, NW, Suite 400
 Washington, DC 20001
 202.638.6300
 www.douglasdevelopment.com

General Contractor

Architect
ANTUNOVICH ASSOCIATES
 ARCHITECTURE • PLANNING • INTERIOR DESIGN
 2206 CLAREMONT BOULEVARD
 SUITE 1150
 LAURENSVILLE, VIRGINIA 22081
 703.224.1124

Landscape Architect

Structural Engineer
MGV Consulting Structural Engineers, Inc.
 6239 Executive Boulevard
 North Bethesda, MD 20852-3906
 301.816.0648
 www.mgvengineers.com

M.E.P. & F.P. Engineers
DJK & Associates, Inc.
 14011 Welland Terrace
 North Potomac, MD 20878
 301.309.6414
 djka@djk-ae.com

Civil Engineer
Dewberry
 2101 Gaither Rd, Suite 340
 Rockville, MD 20850
 301.948.8300
 www.dewberry.com

Project Location
PAPPAS BUILDING
 1401 Okie Street, NE
 Washington DC 20002

Drawing Title
SIGNAGE PLAN

Seal Date: 11/1/18
 Drawn By: RER
 Checked By: AB
 Project No:

Drawing No. **C0003b**

P:\PROJECTS\2015\1401 Okie Street NE_40022700\40022700.dwg, 11/2/2018 8:13:32 AM, rbr
 C:\Users\lvaire\Documents\Hatch_PLD_ARCH.dwg, 11/1/2018 9:46:46 AM